

Agricultural Lands

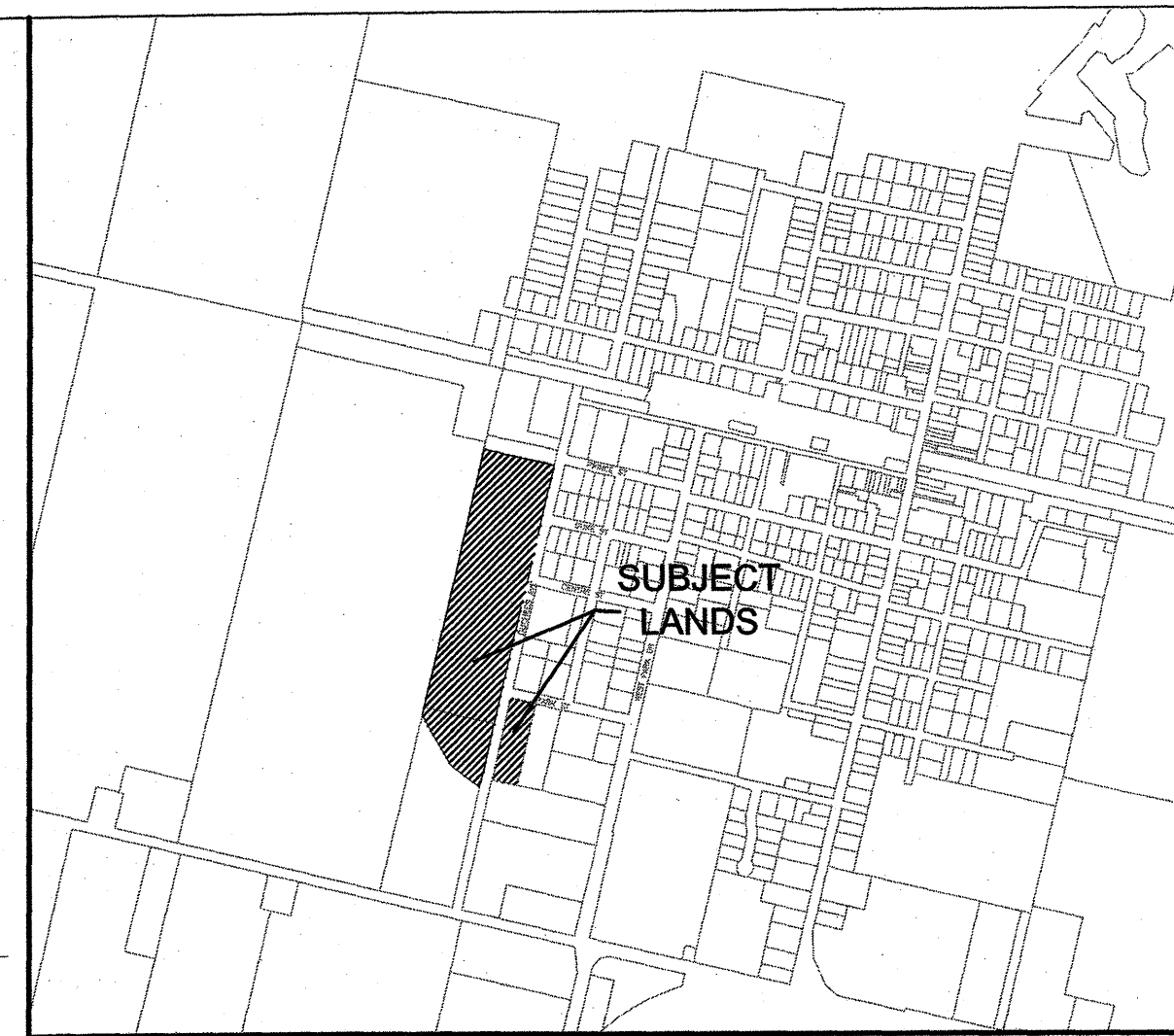

DRAFT PLAN OF SUBDIVISION
OF PART OF
PLAN 562 LOT 53 TO 54, 55, WILLIAMS CON 19 PT LOT 7, PLAN 305 PARK LOT 5
(GEOGRAPHIC TOWNSHIP OF NORTH MIDDLESEX)
IN THE
MUNICIPALITY OF NORTH MIDDLESEX
COUNTY OF MIDDLESEX

OWNER'S AUTHORIZATION
WE HEREBY SUBMIT THIS DRAFT PLAN OF SUBDIVISION
WE HAVE THE AUTHORITY TO BIND THE CORPORATION.

2622954 ONTARIO INC.
PRESIDENT
June 16, 2023
DATED

SURVEYOR'S CERTIFICATE
I HEREBY CERTIFY THAT THE BOUNDARIES OF THE LAND TO BE SUBDIVIDED, AS
SHOWN ON THIS PLAN, AND THEIR RELATIONSHIP TO THE ADJACENT LANDS ARE
ACCURATELY AND CORRECTLY SHOWN.

Trevor D.A. McNeil OLS
June 15, 2023
DATED

**REQUIREMENTS UNDER SECTION
51(17) OF THE PLANNING ACT**

- | | |
|-------------------------|------------------------|
| A: AS SHOWN ON PLAN | G: AS SHOWN ON PLAN |
| B: AS SHOWN ON PLAN | H: PIPED WATER |
| C: AS SHOWN ON KEY PLAN | I: SILTY SAND AND SAND |
| D: RESIDENTIAL | J: AS SHOWN ON PLAN |
| E: AS SHOWN ON PLAN | K: FULL SERVICES |
| F: AS SHOWN ON PLAN | L: AS SHOWN ON PLAN |

LAND USE SCHEDULE

LAND USE	AREA IN HECTARES	%
SINGLE FAMILY (LOTS 1 - 98)	4.62 ha	51.3
TOWNHOUSES (BLOCK 99-108)	1.84 ha	20.4
RIGHT OF WAYS	1.45 ha	16.1
STORMWATER MANAGEMENT (BLOCK 110)	1.10 ha	12.2
TOTAL AREA	9.01 ha	100

No	REVISIONS	DATE	BY

DPOS Application 1 Revised townhouse blocks and SWM block 12/06/2022 KC

**DUCHESS AVE & PARK STREET
WESTWOOD MEADOWS**

SCALE: 1 : 2,200



ZELINKA PRIAMO LTD
A Professional Planning Practice
318 Wellington Road, London, Ontario N6C 4P4
Tel: (519) 474-7137 Fax: (519) 474-2284 e-mail: zp@zplp.com

PROJECT NO.
FVR/PKH/21-01

SHEET NO.

PLAN FILE NO.

